

Sump & Utility Pumps

DISCHARGE 1½" NPT, Female, Vertical
LIQUID TEMPERATURE 104°F (40°C) Continuous
MOTOR HOUSING Cast Iron

PUMP BODY, STRAINER, IMPELLER:

	Thermoplastic
SHAFT	Steel
O-RINGS	Buna-N
HARDWARE	300 Series Stainless Steel
PAINT	Air Dry Enamel
SEAL:	
<i>Design</i>	Single Mechanical, Type 11A
<i>Material</i>	Carbon/Ceramic/Buna-N
<i>Hardware</i>	300 Series Stainless
CORD ENTRY	9 ft. (2.7m) Cord with plug and Pressure Grommet for sealing and strain relief
BEARINGS	Single Row, Ball, Oil Lubricated
MOTOR:	
<i>Design</i>	Oil Filled
<i>Insulation</i>	Class B
SINGLE PHASE	Permanent Split Capacitor (PSC). Includes thermal overload protection in motor
LEVEL CONTROL	Vertical Float Integral to Pump
MINIMUM SUMP DIA	14" (355mm)
NOTE	GFCI Compatible to Comply with NEC 210.8 (A)



Series: ESB33
1/3HP, 3450RPM, 60Hz

DESCRIPTION:

PUMP FOR RESIDENTIAL SUMP APPLICATIONS



WARNING:

CANCER AND REPRODUCTIVE HARM -
WWW.P65WARNINGS.CA.GOV

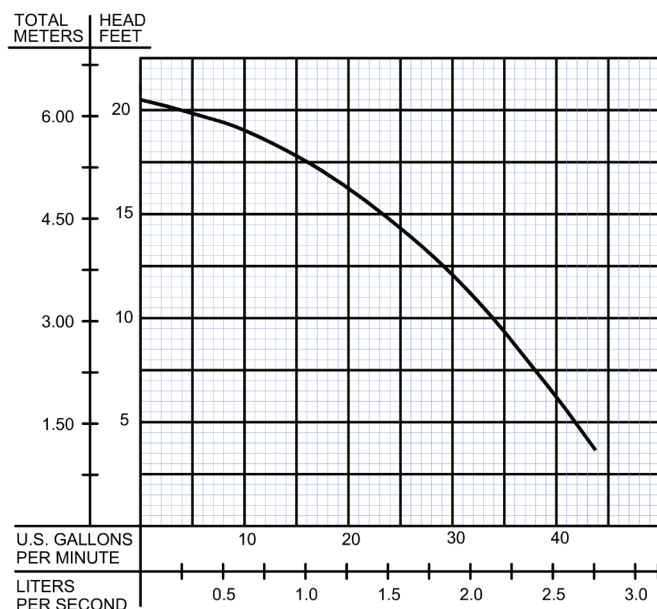

Testing is performed with water specific gravity of 1.0 @ 68°F (20°C),
other fluids may vary performance

Sump & Utility Pumps

Model: ESB33

inches
(mm)

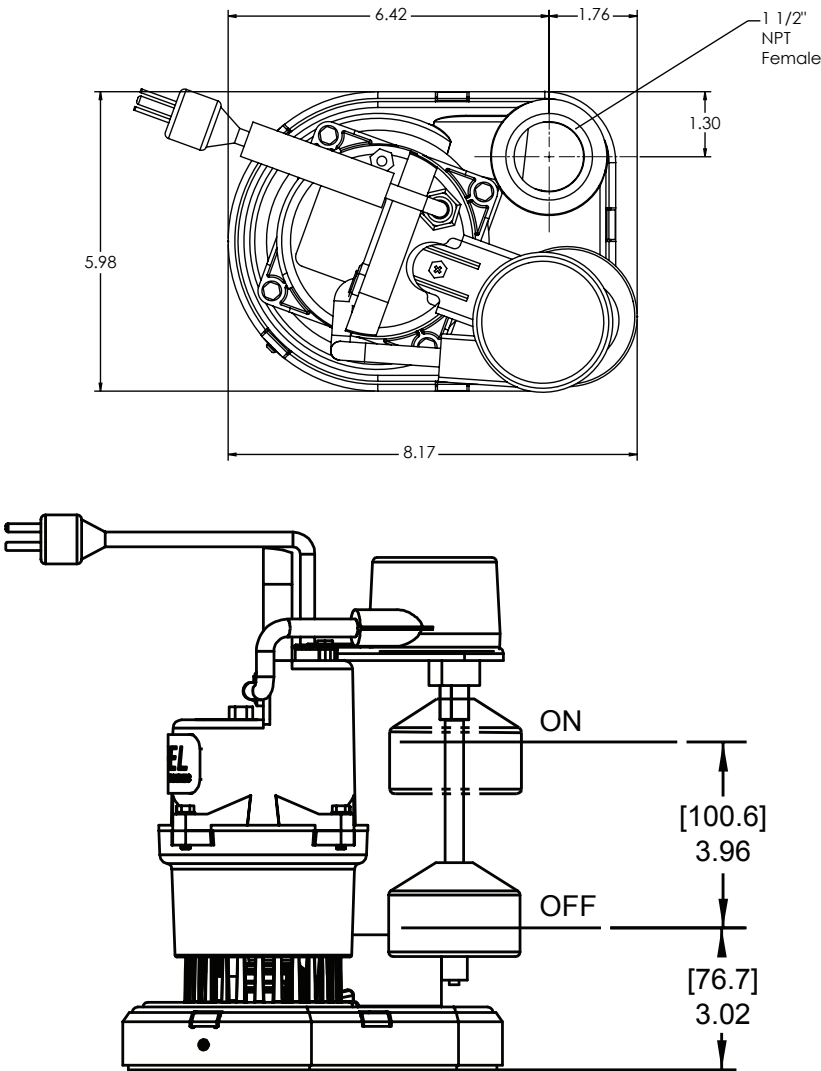

MODEL NO	PART NO	HP	VOLT/PH	Hz	RPM (Nom)	NEMA START CODE	FULL LOAD AMPS	CORD LENGTH	CORD SIZE	CORD TYPE
ESB33	130234A	1/3	120/1	60	3450	A	3.4	9 ft. (2.7m)	18	SJTW

IMPORTANT !

- 1.) PUMP MAY BE OPERATED "DRY" FOR EXTENDED PERIODS WITHOUT DAMAGE TO MOTOR AND/OR SEALS.
2.) INSTALLATIONS SUCH AS DECORATIVE FOUNTAINS OR WATER FEATURES PROVIDED FOR VISUAL ENJOYMENT MUST BE INSTALLED IN ACCORDANCE WITH THE NATIONAL ELECTRIC CODE ANSI/NFPA 70 AND/OR THE AUTHORITY HAVING JURISDICTION. THIS PUMP IS NOT INTENDED FOR USE IN SWIMMING POOLS, RECREATIONAL WATER PARKS, OR INSTALLATIONS IN WHICH HUMAN CONTACT WITH PUMPED MEDIA IS A COMMON OCCURRENCE.